

FLEXITRAILER FT-LS-S

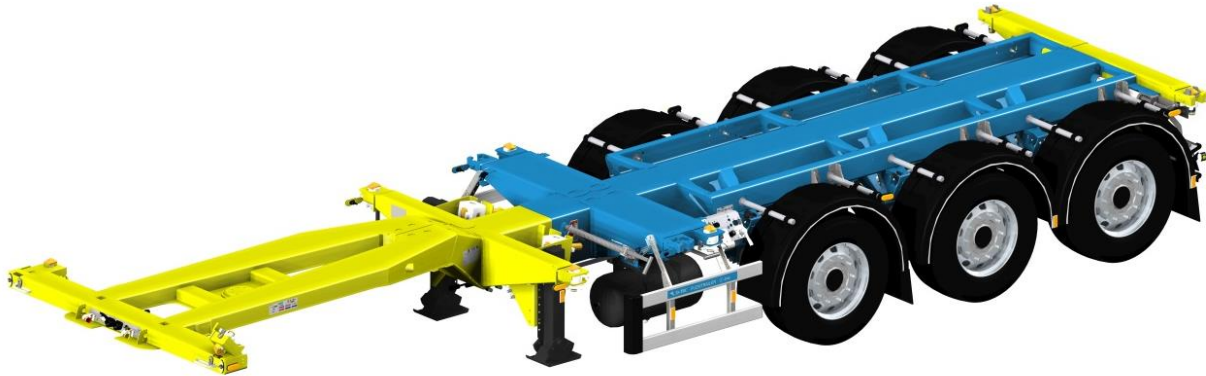

Technische gegevens

Geschikt voor

Schoteldruk
 Maximale aslast per as
 Totaal toegestane massa
 Leeggewicht
 Nuttig laadvermogen
 Schotelhoogte
 Chassishoogte
 Bandenmaat
 Elektrische aansluitingen



Technische Daten

Geeignet für

Sattellast
 Max. Achslast per Achse
 Gesamt zulässige Masse
 Leergewicht
 Nutzlast
 Sattelhöhe
 Chassishöhe
 Reifengröße
 Elektrische Anschlüsse



Technical data

Suitable for

Kingpin weight
 Maximal Axleload / axle
 Gross trailer weight
 Empty weight
 Payload
 Fifthwheel height
 Chassisheight
 Tyresize
 Electrical connectors

FT-LS-S

20 ft rear
 30 ft
 2x 20 ft
 40 ft (HC)
 45 ft
 16.000 kg
 9.000 kg
 43.000 kg
 4.600 kg
 38.400 kg
 1.110 mm
 1.110 mm
 385/55 R22,5
 2x 7-pin + 1x 15 pin

OPTIES / OPTIONEN / OPTIONS

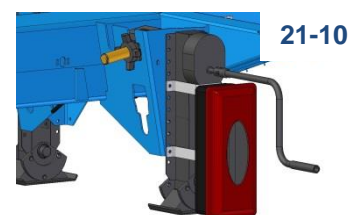
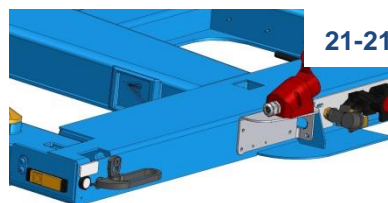
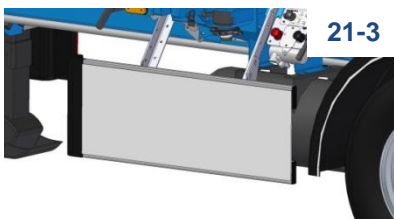
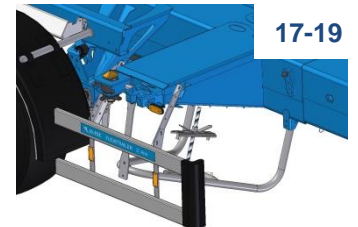
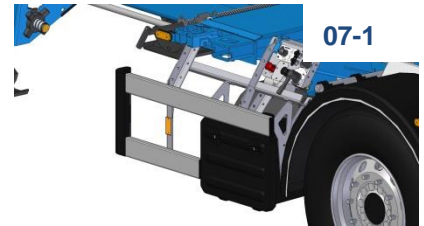
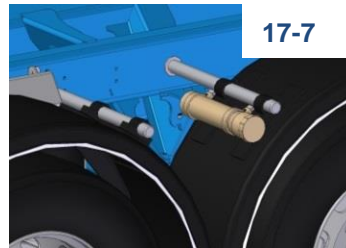
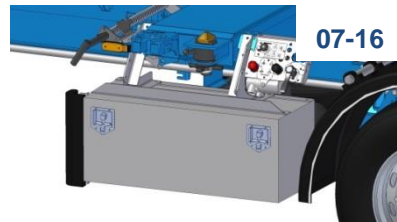
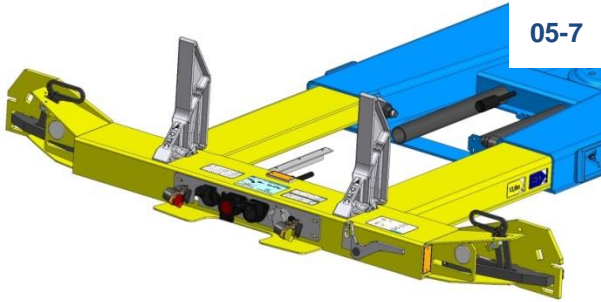

					
Basis opties		Basis Optionen		Basic options	
11-4-15	Valx trommelremmen As 1 liftas manueel / automatisch	Valx Trommelbremsen Achse 1 Liftachse man. / automatisch	Valx drumbrakes Axle 1 liftaxle manual / automatic		
19-55	Bandenmaat 385/55R22,5	Reifengröße 385/55 R22,5	Tyresize 385/55 R22,5		
19-B	Banden keus D-TEC 1 laag 2K natlak RAL 5015 / 9005	Reifen nach Wahl D-TEC 1 Schicht 2K RAL 5015 / 9005	Tyremake D-TEC choice 1-Layer coating 2K RAL 5015 / 9005		
09-1-2	Bovenzijde schooperen	Oberseite spritzverzinkt	Topside schooping		
05-7	Flexilock voor 45' legaal	Flexilock für 45' legal	Flexilock for 45' legal		
21-5	2 Wielkeggen	2 Radkeile	2 Wheelwedges		
21-16	Containerstops	Containerstops	Containerstops		
Comfort opties		Komfort Optionen		Comfort options	
11-4-8	VALX / Mercedes-Benz / SAF schijf BPW trommelremmen	VALX / Mercedes-Benz / SAF Scheibe BPW Trommelbremsen	VALX / Mercedes-Benz / SAF disc BPW drumbrakes		
11-2-17	laatste as naloop gestuurd As 1 aut. / handm. liftas, as 3 handm.	Letzte Achse nachlaufgelenkt A. 1 aut. / man. Liftachse, A. 3 man.	Last axle steeringaxle A. 1 aut./man. liftaxle, axle 3 manual		
11-15	ATO	ATO	ATO		
19-65	Bandenmaat 385/65R22,5. Continental HTR2 /	Reifengröße 385/65 R22,5 Goodyear LHT II / GT /	Tyresize 385/65 R22,5 Michelin XTE3		
19-7-3	Alcoa Durabright 6 alu velgen Reservewiel staal 385/65 of 55	Alcoa Durabright 6 alu Felgen Reserverad Stahlfelge 385/65 oder 55	Alcoa Durabright 6 alloy rims Sparewheel steel 385/65 or 55		
09-1-1	Volledig schooperen Standard Coating in RAL 3002,	Völlig spritzverzinkt RAL 5002, RAL 5010, RAL 5015,	Full schooping RAL 7016, RAL 7021, RAL 9005		
09-6-SP	sputen 2-laags 2K natlak naar keuze	Lackieren 2 Schicht 2K nach Wahl	2-Layer coating 2K customer choice		
09-4-3	naven + doppen sputen	Naben und Kappen lackiert	Hubs and caps painted		
15-12	6x ronde 3-kamer lampen, alles LED	6x Runde 3-Kammerleuchten LED	6 Round lights, LED		
05-17	Klapkokers ivm geen tunnel	Klappstützen wegen ohne Tunnel	Filling pieces due to no tunnel		
07-1	Kunststof gereedschapskist links.	Kunststoff Werkzeugkasten links	Plastic toolbox		
07-11	Verhoogde stekkerplaat	Erhöhte Anschlüsse vorne	Higher connectors at the front		
07-16	RVS gereedschapskist links	V2A Werkzeugkasten links / rechts	Stainless steel toolbox left / right		
07-26	Rolletjes onder achterkoker	Rollen unter Heckausschub	Bearings for easier cranking out		
07-3	Kingpenslohouder	Halter für Königszapfenverriegelung	Holder for kingpinlock		
07-5	Gevaarlijke stoffen bord	Gefahrgutschild	ADR sign at the rear, orange		
07-NS-9	Reclameplaat	Werbungstafel Stahl am Heck	Steel plate at the rear, painted		
17-19	Reservewieldrager	Reserveradträger	Sparewheelcarrier		
17-7	Documenten koker uit plastic.	Dokubox Kunststoff	Document tube		
17-21	Brede spatlap onder de bumper	Breiter Schmutzfänger	Mudflap under bumper		
21-10	Houder zonder 6 kg brandblusser	Halter ohne 6kg Feuerlöscher	Holder without 6kg fire extinguisher		
21-21	Vorbereiding genset	Vorbereitung Genset	Genset preparation		
21-3	Zijbeplating witte trespa	Seitl. Unterfahrschutz Trespa, weiß	Trespa sidefenders, white		
21-8	Kingpinslot	Königszapfenverriegelung	Kingpinlock		
03-4-A	ADR-fabrikantverklaring	ADR Herstellerbestätigung	ADR Manufacturer certificate		
25-NS-2	LZV uitgevoerd en gekeurd	nur für NL	only NL		
17-2	ADR/VLG uitvoering incl certificaat	nur für NL	only NL		

